

Introduction

The Ooma Safety Phone is a small speaker phone that can be worn or kept by your side all day.

Since the Safety Phone is a fully-working speaker phone capable of two-way communication, you can use it to make and receive calls anywhere within the range of your home Ooma system.

Comfortable to wear and programmable with up to two speed dial numbers, the Safety Phone gives you the peace of mind that your caretaker and loved ones are just a button press away. The Safety Phone can effectively support your independent lifestyle.

Important Information About the Safety Phone

- Carefully read and follow the instructions in this Quick Start Guide, which may also be viewed online at:

<http://www.ooma.com/support/documentation>

Do not use the Safety Phone if you cannot understand and follow the instructions.

- Use of the Safety Phone requires high-speed Internet access and the Ooma Telo device. The Safety Phone will not work if either the Internet or Ooma Telo are not functioning properly.

- The Safety Phone is intended for indoor use with a range of up to 50 meters (164 feet) from the Ooma Telo. This range may vary based on factors such as home construction and other electrical devices and appliances being used in the home.

- The battery in the Safety Phone is not replaceable. The expected lifetime of the battery is two years, but may vary based on usage.

- Do not use the Safety Phone if you have an implanted cardiac pacemaker.



WARNING: To avoid injury, please review the Important Safety Information section on page 11 before using the Safety Phone.

Package Contents

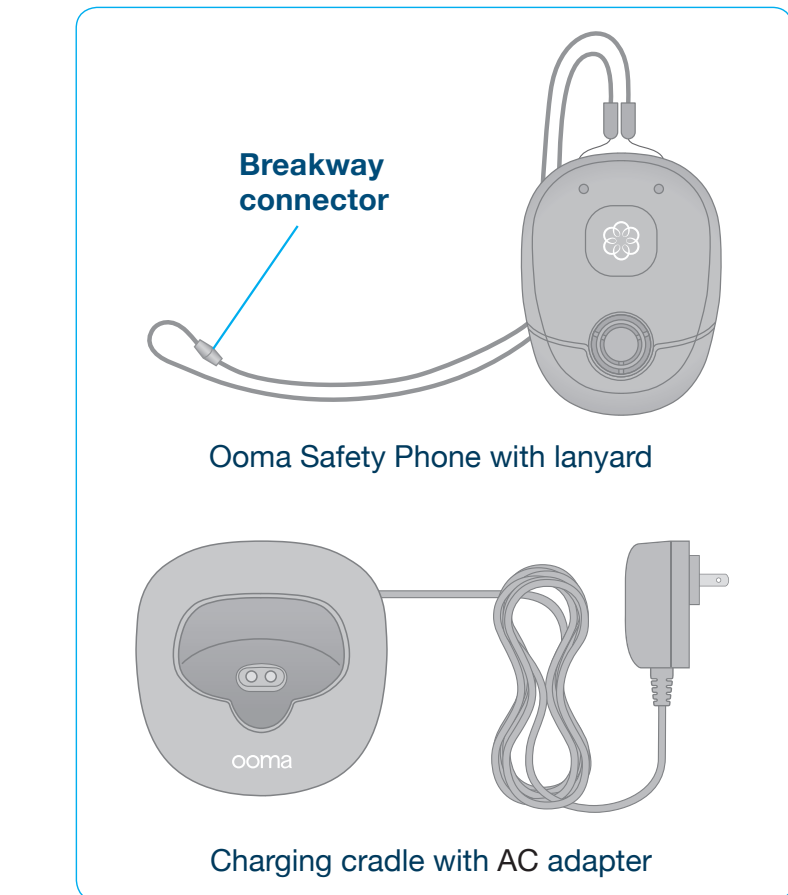

Step 1 Charge Phone

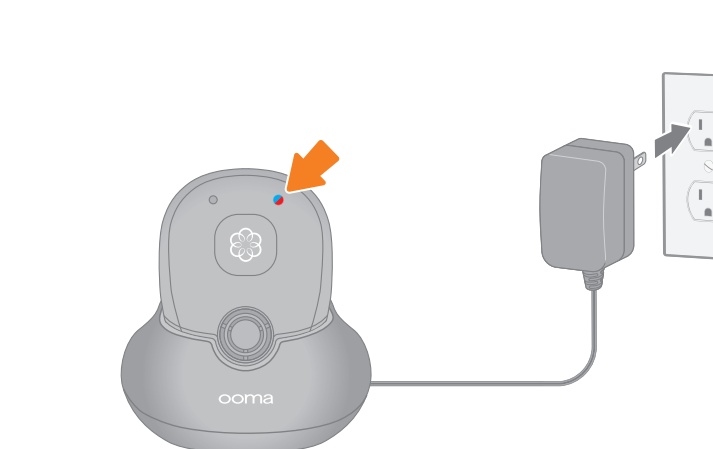

Place the Safety Phone on the charging cradle and charge for a few minutes until the status LED turns purple and you start to hear the Safety Phone play two short beeps periodically.

When you are ready to register the phone, take it out of the cradle and put it back in. The status LED will start to blink red and blue.

Step 2 Register Phone

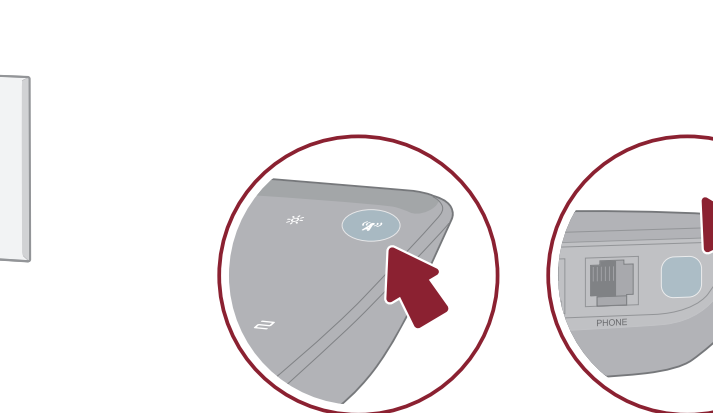

Press and hold the **PAGE** button on your Ooma device for three seconds to activate registration mode.

The Safety Phone will now register with your Ooma system. When the registration process is successful, you will hear a long beep.

Continue to charge the Safety Phone for at least three hours until the status LED lights up solid blue.

Step 3 Program Speed Dial Online

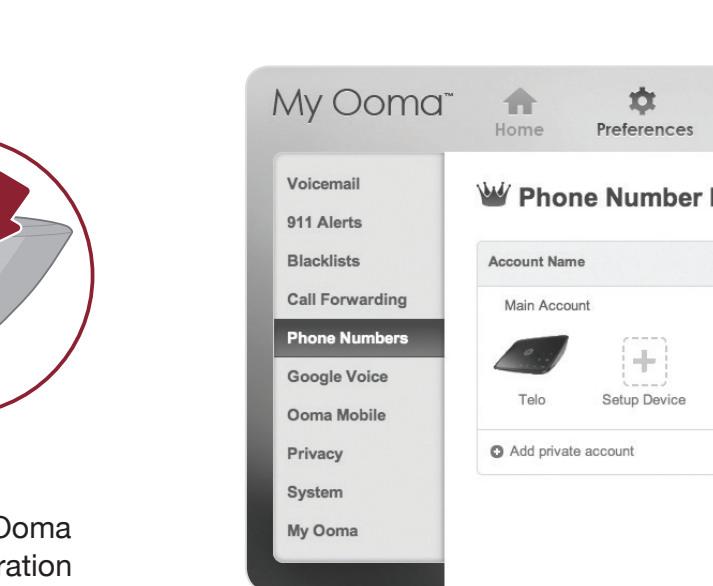

Finish the installation process by going to: <http://my.ooma.com/devices>

Here you will be able to program the two speed dial buttons.

Quick Reference Guide

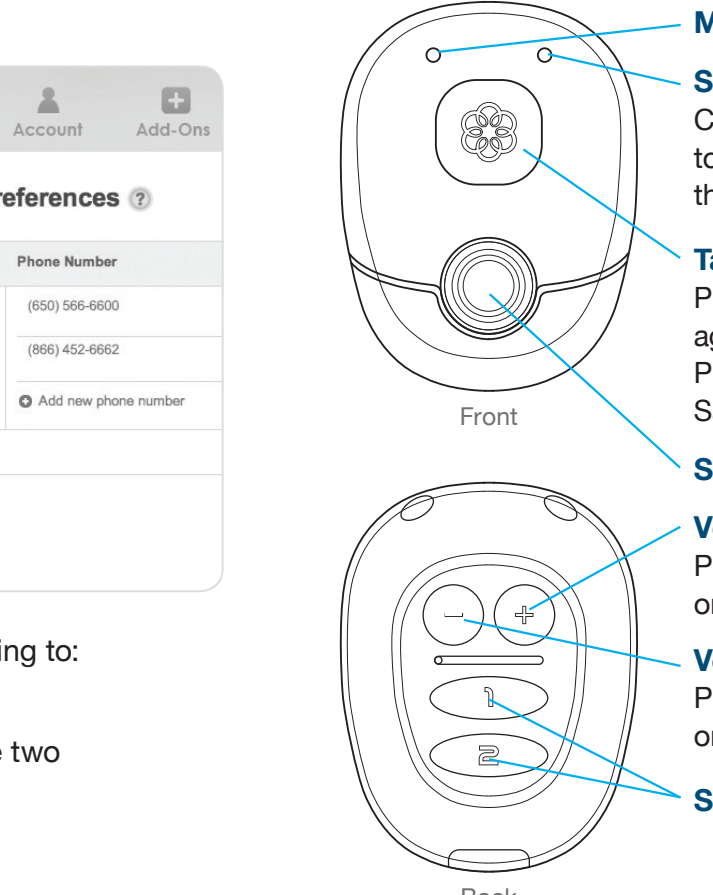

Operation Instructions

- Powering the Safety Phone on or off**
To power the phone on or off, press and hold the **TALK** button until you hear three short beeps.

- Making an outgoing call**
Outgoing calls can be placed to either of the two pre-programmed speed dial buttons. Press the appropriate button to call the programmed number.

- Answering a call**
Answer incoming calls by pressing the **TALK** button.

- Ending a call**
To end a call, press the **TALK** button again while on a call. You can also end a call by putting the Safety Phone back onto the charging cradle.

- Adjusting the volume**
The speaker volume can be adjusted up by pressing the **VOLUME UP** or **VOLUME DOWN** button during a call. Use the same buttons to adjust the ringer volume when the phone is in idle mode.

- Registering to a new base unit**
Register the Safety Phone to a different base unit by pressing and holding the **VOLUME UP** and **VOLUME DOWN** buttons at the same time until the status LED toggles between red and blue.

LED Indicators

The status LED on the Ooma Safety Phone can communicate information about the connection and battery status of the device. The table below shows the different indicator patterns that the phone uses:

Purple	Steady	Phone is unregistered
	Flashing	Phone is registered, but it cannot connect to your Ooma system (searching or out of range)
Blue	Steady	Phone is seated in the charging cradle and fully charged.
	Long flashing	Phone is in idle mode and not charging.
	Double flashing	Phone is on and connected to a phone call.
	Continuously flashing	Phone is ringing.
Red	Steady	Phone is charging on its cradle.
	Flashing	Battery is low and the phone needs to be returned to its charging cradle.
	Double flashing	Phone is in use and the battery is low.
	Triple flashing	Phone is powering off.
Red/Blue	Toggle	Phone is in registration mode.

Audio Indicators

The Ooma Safety Phone also uses audio indicators to communicate changes in the device status. See below for a table of audio prompts:

Long beep	The phone has successfully registered to your Ooma system.
Two short beeps	Battery is low and the phone must be returned to charging cradle.
Three short beeps	The phone is on but the signal is weak. Phone is powering on / off.



Need Assistance?

Check out these resources for troubleshooting guides or additional help:

Online knowledgebase: www.ooma.com/support
User manuals: www.ooma.com/userguide
Community forum: forums.ooma.com
Live customer care: **1-888-711-6662 (US)**
1-866-929-6662 (Canada)

Important Safety Information

WARNING: Failure to follow these safety instructions could result in fire, electric shock, or other injuries, or damage to the Ooma Safety Phone or other property. The Safety Phone and its accessories must be operated only for its intended use and not for any other purposes. Read all the safety information below before using the Ooma Safety Phone.

- This product contains a non-replaceable lithium-ion battery. There is risk of explosion, fire, burn or leaking which can be caused by improper charging, shorting of the battery, or other misuse. Always use the charger provided with the product. DO NOT attempt to disassemble, replace, or otherwise attempt to access the battery.
- **This unit is NOT waterproof.** DO NOT expose this product to water, rain, moisture, other liquids (alcohol, etc.) or submerge in water or other liquids for any reason. DO NOT bath or shower while wearing or using this product.
- DO NOT bath or shower while wearing or using this product. DO NOT use this product near water, for

example, near a wash bowl, kitchen sink or laundry tub, in a wet basement or near a swimming pool.

- Objects worn around the neck may pose a risk of injury, including strangulation. Use the lanyard with caution. DO NOT attempt to disable the break-away feature on the lanyard as this may increase the risk of injury. Keep the lanyard away from children.

- Avoid using this product during an electrical storm. There may be a remote risk of electric shock from lightning.

- DO NOT use this product to report a gas leak in the vicinity of the leak.

- DO NOT use this product if you have an implanted cardiac pacemaker.

Limited Warranty

What this Warranty Covers. Ooma agrees to provide a limited warranty to the holder of a valid proof of purchase (“Consumer” or “you”) that the Ooma Safety Phone contained in this package (“Product”) is free from material defects in material and workmanship, subject to the exclusions noted below. This limited warranty extends only to the Consumer for Products purchased and used in the United States of America or Canada.

What Ooma Will Do. During the warranty period, Ooma or its authorized service representative will repair or replace, at its option, without charge, a Product which is found to be materially defective in materials or workmanship and returned to Ooma. Ooma, at its option, may use new or refurbished replacement parts to repair the Product, or may replace the Product with a new or refurbished product having the same or similar function.

How Long this Warranty Lasts. This limited warranty shall expire one (1) year from the date of the Product purchase. Replacement or refurbished parts and products are warranted for the original Product warranty period. This warranty terminates if you sell or transfer your Product.

What this Warranty Excludes. This limited warranty does not cover: (a) the cost of shipping and handling for returned and replacement products, or damage or loss during shipment for warranty service; or (b) any software (which is governed exclusively by the licensing terms of such software); or (c) any Product that has been subjected to misuse, accident, shipping or other physical damage, improper installation, abnormal operation or handling that is contrary to operation instructions, neglect, acts of god, inundation, fire, water or other liquid intrusion, or force majeure; or (d) any Product that has been damaged due to repair, alteration, or modification by anyone other than an authorized service representative of Ooma; or (e) any Product to the extent that the problem experienced is caused by signal conditions, network reliability or cable or antenna systems; or (f) any Product whose identifying information has been removed, altered or rendered illegible; or (g) any Product purchased, used, serviced, or shipped for repair from outside the United States or Canada, or that is returned without a valid proof of purchase; or (h) any indirect or consequential harm caused as a result of any defect or failure of the Product to properly operate, including without limitation lost data or inability to communicate.

How to Get Warranty Service. To obtain warranty service, call Customer Support toll-free at **1-888-711-6662 (USA)** or **1-866-929-6662 (Canada)** for detailed information, including instructions on how and where to return your Product and on any applicable costs associated with a repair, replacement or exchange. You may be required to provide proof of purchase before obtaining warranty service, and it is your sole responsibility to maintain such proof (e.g., a sales receipt).

Returned products that are determined not to be materially defective will be subject to a handling fee. If you disagree with any of our decisions with respect to warranty service, you have the right to contest that decision as permitted under applicable laws and regulations.

How State Law Applies. This limited warranty gives you specific legal rights. You may also have other rights which vary from state to state.

Warranty Disclaimer and Limitation on Liability. THIS WARRANTY IS THE COMPLETE AND EXCLUSIVE WARRANTY AGREEMENT FOR THE OOMA SAFETY PHONE BETWEEN YOU AND OOMA. NO ONE IS AUTHORIZED TO MAKE MODIFICATIONS TO THIS LIMITED WARRANTY AND YOU SHOULD NOT RELY ON ANY SUCH MODIFICATION. OOMA RESERVES THE RIGHT TO CHANGE ITS LIMITED WARRANTY WITHOUT PRIOR NOTICE FOR FUTURE SALES. OOMA DISCLAIMS ALL OTHER WARRANTIES WITH RESPECT TO ITS PRODUCTS, WHETHER EXPRESS, IMPLIED, STATUTORY OR OTHERWISE, INCLUDING WITHOUT LIMITATION, COURSE OF DEALING, TRADE USAGE OR PRACTICE OR THE WARRANTIES OF MERCHANTABILITY, FITNESS FOR A PARTICULAR PURPOSE, TITLE, OR NON-INFRINGEMENT OF THIRD PARTY RIGHTS. MOREOVER, OOMA SHALL NOT BE LIABLE FOR INDIRECT, INCIDENTAL, SPECIAL, EXEMPLARY, PUNITIVE, OR CONSEQUENTIAL DAMAGES OF ANY NATURE ARISING OUT OF, OR IN CONNECTION WITH, THE LIMITED WARRANTY OR THE USE OR PERFORMANCE OF ANY PRODUCT, WHETHER BASED ON CONTRACT OR TORT, INCLUDING NEGLIGENCE, OR ANY OTHER LEGAL THEORY, EVEN IF WE HAVE BEEN ADVISED OF THE POSSIBILITY OF SUCH DAMAGES. THE TOTAL AGGREGATE LIABILITY BY OOMA FOR DAMAGES OF ANY NATURE, REGARDLESS OF FORM, ACTION OR FORESEEABILITY, SHALL IN NO EVENT EXCEED THE AMOUNT PAID BY YOU TO US FOR THE OOMA SAFETY PHONE UPON WHICH LIABILITY IS BASED. SOME STATES AND/OR COUNTRIES DO NOT ALLOW LIMITATIONS ON HOW LONG AN IMPLIED WARRANTY LASTS, AND/OR DO NOT ALLOW THE EXCLUSION OR LIMITATION OF INCIDENTAL OR CONSEQUENTIAL DAMAGES, SO THE ABOVE LIMITATIONS AND/OR EXCLUSIONS MAY NOT APPLY TO YOU. IF SUCH IS THE CASE, TO THE EXTENT PERMITTED BY APPLICABLE LAW, OOMA LIMITS THE DURATION OF ANY IMPLIED WARRANTIES TO THE DURATION OF THIS EXPRESS LIMITED WARRANTY.

Disclaimer of Liability and Indemnification: YOU UNDERSTAND AND AGREE THAT OOMA IS NOT RESPONSIBLE, AND DISCLAIMS ALL LIABILITY FOR, RELATED TO, OR ARISING OUT OF, YOUR FAILURE TO (I) CHARGE THE OOMA SAFETY PHONE, (II) REGISTER THE OOMA SAFETY PHONE, (III) ENTER IN THE CORRECT INFORMATION WHILE PROGRAMMING

THE OOMA SAFETY PHONE ONLINE, OR (IV) TEST THE FUNCTION AND RANGE OF THE OOMA SAFETY PHONE AND THE OOMA SERVICES. WE DO NOT HAVE ANY CONTROL OVER WHETHER, OR THE MANNER IN WHICH, CALLS USING OUR 911 DIALING SERVICE ARE ANSWERED OR ADDRESSED BY ANY EMERGENCY RESPONSE CENTER. WE DISCLAIM ALL RESPONSIBILITY FOR THE ABILITY OF THE OOMA SAFETY PHONE TO CONNECT TO AN EMERGENCY RESPONSE CENTER, THE CONDUCT OF THE EMERGENCY RESPONSE CENTER AND THE NATIONAL EMERGENCY CALLING CENTER. WE RELY ON THIRD PARTIES TO ASSIST US IN ROUTING 911 CALLS TO EMERGENCY RESPONSE CENTERS AND TO A NATIONAL EMERGENCY CALLING CENTER. WE DISCLAIM ANY AND ALL LIABILITY OR RESPONSIBILITY IN THE EVENT SUCH THIRD PARTY DATA USED TO ROUTE CALLS IS INCORRECT OR YIELDS AN ERRONEOUS RESULT. WE DO NOT HAVE ANY CONTROL OVER THE ACTIONS OR OMISSIONS OF YOUR ALERT CONTACTS (AS PROGRAMMED BY YOU UPON REGISTRATION OR THEREAFTER), OR THE INTERNET CONNECTION OR MOBILE TELEPHONE CARRIER SERVICES UTILIZED BY YOU OR YOUR ALERT CONTACTS. NEITHER OOMA NOR ITS OFFICERS OR EMPLOYEES MAY BE HELD LIABLE FOR ANY CLAIM, DAMAGE, OR LOSS, AND YOU HEREBY WAIVE ANY AND ALL SUCH CLAIMS OR CAUSES OF ACTION, ARISING FROM OR RELATING TO OUR 911 DIALING SERVICES. YOU SHALL DEFEND, INDEMNIFY, AND HOLD HARMLESS OOMA, ITS OFFICERS, DIRECTORS, EMPLOYEES, AFFILIATES, AGENTS, AND ASSIGNS, AND ANY OTHER SERVICE PROVIDER WHO FURNISHES SERVICES TO YOU IN CONNECTION WITH THE OOMA SAFETY PHONE OR SERVICES, FROM ANY AND ALL CLAIMS, LOSSES, DAMAGES, FINES, PENALTIES, COSTS, AND EXPENSES (INCLUDING, WITHOUT LIMITATION, ATTORNEYS' FEES) BY, OR ON BEHALF OF, YOU OR ANY THIRD PARTY RELATING TO THE ABSENCE, FAILURE, OR OUTAGE OF THE OOMA SAFETY PHONE OR OOMA SERVICE, INCLUDING 911 DIALING AND 911 ALERTS, INCORRECTLY ROUTED 911 DIALING CALLS AND INCORRECTLY ROUTED ALERT EMAILS OR TEXT MESSAGES, INCORRECTLY ENTERED EMAIL ADDRESSES OR MOBILE TELEPHONE NUMBERS FOR THE ALERT CONTACTS, AND/OR THE INABILITY OF ANY USER OF THE OOMA SAFETY PHONE TO BE ABLE TO USE OOMA SERVICE, 911 DIALING, 911 ALERTS, OR ACCESS EMERGENCY SERVICE PERSONNEL. IF YOU ARE NOT COMFORTABLE WITH THE LIMITATIONS OF THE 911 DIALING SERVICE, YOU SHOULD HAVE AN ALTERNATIVE MEANS OF ACCESSING TRADITIONAL 911 SERVICES. IF YOU ARE NOT COMFORTABLE WITH THE LIMITATIONS OF THE OOMA SAFETY PHONE, OOMA SERVICE, 911 DIALING, OR 911 ALERTS SERVICE, YOU SHOULD NOT ENABLE AND/OR USE THE OOMA SAFETY PHONE.

Compliance Information

Any changes or modifications to this product not expressly approved by the manufacturer or other party responsible for compliance could void your authority to operate this product.

FCC Part 15 Information

This device complies with part 15 of the FCC rules. Operation is subject to the following two conditions: (1) This device may not cause harmful interference, and (2) This device must accept any interference received, including interference that may cause undesired operation. Privacy of communications may not be ensured when using this phone.

FCC PART 15.105(b): Note: This equipment has been tested and found to comply with the limits for a Class B digital device, pursuant to part 15 of the FCC Rules. These limits are designed to provide reasonable protection against harmful interference in a residential installation. This equipment generates, uses and can radiate radio frequency energy and, if not installed and used in accordance with the instructions, may cause harmful interference to radio communications. However, there is no guarantee that interference will not occur in a particular installation. If this equipment does cause harmful interference to radio or television reception, which can be determined by turning the equipment off and on, the user is encouraged to try to correct the interference by one or more of the following measures:

- Reorient or relocate the receiving antenna.
- Increase the separation between the equipment and receiver.
- Connect the equipment into an outlet on a circuit different from that to which the receiver is connected.
- Consult the dealer or an experienced radio/TV technician for help.

RF Exposure Information

This product complies with FCC radiation exposure limits under the following conditions:

- The base must be placed to allow a minimum of 20 cm (8 inches) between the antenna and all persons during normal operation.
- The base must not be collocated or operated in conjunction with any other antenna or transmitter.

Industry Canada (I.C.) Notice

Terminal equipment
NOTICE: This equipment meets the applicable Industry Canada Terminal Equipment Technical Specifications. This is confirmed by the registration number. The abbreviation IC before the registration number signifies that registration was performed based on a Declaration of Conformity indicating that Industry Canada technical specifications were met. It does not imply that Industry Canada approved the equipment.

Radio equipment

The term IC before the radio certification number only signifies that Industry Canada technical specifications were met. Operation is subject to the following two conditions: (1) this device may not cause interference, and (2) this device must accept any interference, including interference that may cause undesired operation of the device. “Privacy of communications may not be ensured when using this telephone”.

IC Number: 1135B-80949600

Copyright Notices

© 2014 Ooma, Inc. All rights reserved. Reproduction in whole or in part without written permission is prohibited. Ooma, the Ooma logo, Ooma Telo, Ooma Safety Phone and all other Ooma company, product and service names and slogans are trademarks of Ooma, Inc. All other product, service or brand names are the property of their respective owners. Patent pending.

The phone is designed for body-worn operation and meets FCC RF exposure guidelines when used with any belt clip, carrying case, or other accessory supplied with this product. (All necessary accessories are included in the package; any additional or optional accessories are not required for compliance with the guidelines.) Third party accessories (unless approved by the manufacturer) should be avoided as these might not comply with FCC RF exposure guidelines.